

Products included in Starter Set
See Appendix 2.

GENERAL INSTRUCTIONS:

Preheat your oven to 275 degrees. Place oven thermometer (J) provided in the center of your oven for an accurate oven temperature measurement.

Choose backing clay (A). Unwrap brick from plastic package, use your hands to roll and fold clay for several minutes to condition. Separate about 1/4 of the brick and form into rectangle. Place on PSI glass working surface (B). Use PSI acrylic roller (C) to flatten clay into even thickness. **(Fig 1)** (PSI pasta machine may be used in place of



Select cutter from Tube Size cutter set (F) to correspond with diameter of brass tube provided in your pen kit. Flatten clay to be as wide as selected cutter, and as long as brass tube in project pen kit (E) (Fig 2).

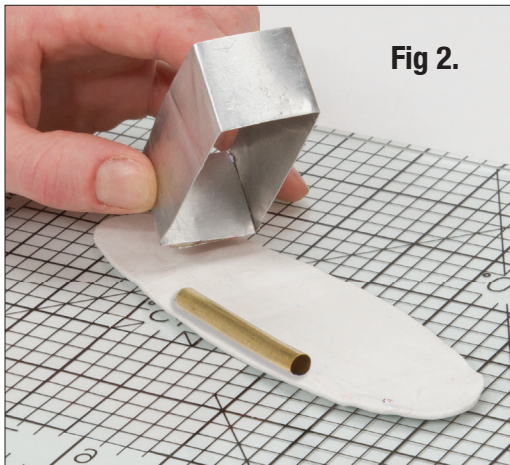

Fig 2.



Unwrap clay cane (G) of your choice. Place cane in PSI slicing jig (H) in slot that fits cane diameter tightly. Push cane to hang slightly over edge.

Slide PSI blade (I) downward slowly, against side of cutting jig to cut completely through cane. Repeat for desired number of slices. **Fig 3).**

Lay cane slices on previously flattened clay in desired pattern. Judge width of coverage by previously selected Tube Size

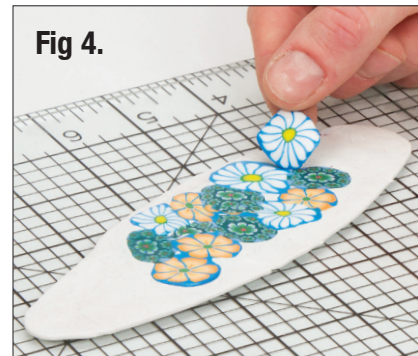
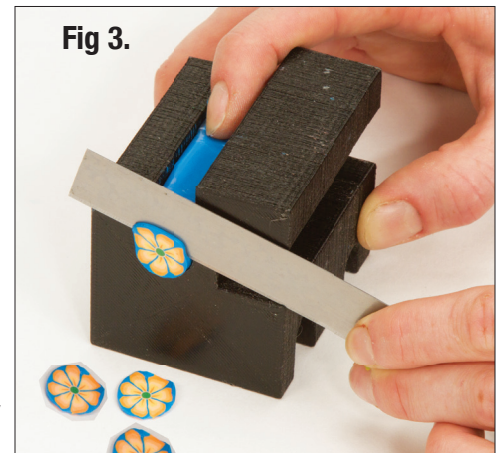

Wrap sheet of clay around brass tube tightly, be sure seams touch (**Fig 6**). Mount clay laminated pen tube onto Poly Clay Mandrel (K), mount the tube with bushings (L), as shown in **Fig(7)**. Tighten assembly. Roll ends of clay-laminated tube on work surface to match bushing diameters. Or use your fingers to knead and roll the clay if necessary.

Position large bushings onto the ends of the mandrel. Place assembly on baking sheet. (**Fig 8**). Bake at 270 degrees for 30 minutes, periodically check oven temperature. Cool completely. It's OK to run the hot clay under water to cool faster. (If not

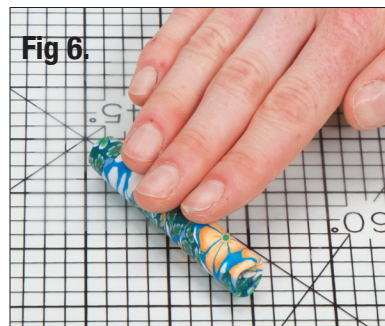

using an oven dedicated to polymer clay, cover baking sheet with tin foil to contain fumes. Do not let foil touch clay). When cooled, remove large end bushings. Insert unthreaded end of mandrel into power drill. Place a bowl of warm water nearby with Abralon sanding pads (M) in the bowl. Start with

lowest number grit. Set drill speed to a minimum of 500 R.P.M.'s. Cup pad grit side up. Start drill and bring pad up to make contact with barrel as it spins (**Fig 9**). Repeat process with each higher grit. Until you've sanded with all 8 grits. Remove any residue with damp cloth. Buff barrel with a soft cloth (polar fleece recommended). Optional finishing on lathe: Mount mandrel assembly on lathe (use chuck or drill chuck in headstock). Use traditional lathe tools to turn smooth, finish sand and polish. Optional Finishing: apply Aussie oil or One Step polish with paper towel while drill spins. Repeat to apply multiple coats.



Buff with a cloth until smooth, even finish is achieved. Remove barrel from mandrel. Use instructions provided in pen kit for assembly. Use a PSI Pen Press for best results.

Fig 8.



Temperature and time may vary 5-10% if necessary to optimize curing results for clay

Fig 9.

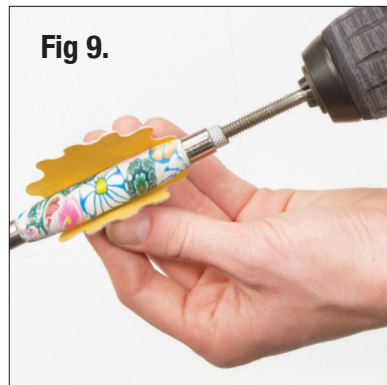

(**Fig 10**). Note: Pen instructions will include "turning instructions" for the lathe. Disregard this section, skip to parts diagram and assembly instructions: these will be exactly the same for your poly clay decorated pen.

Fig 10.



Appendix 1. Clay conditioning machine instructions.



Line the machine up to the edge of a table with the side that takes the handle closest to the edge. Place one end of the provided clamp into the hole on the base and tighten to the table. Number 1 on the dial is the thickest setting. Cut the clay into thin slices before you place it through the rollers to extend the life of your machine. Place the clay against the edge of the rollers and turn the handle pushing the clay through until it catches and continue turning the handle until the clay comes out the bottom. To adjust thickness pull the knob out and turn to the desired number and release the knob making sure the knob tooth is lined up. To clean the machine, run a wet wipe over the top and bottom of the rollers removing any clay residue

Appendix 2. Products included in Starter Set #MSM-SS1

- (A) Backing Clay (2 bricks included): #MCM-K04 White, #MCM-K36 Black
- (B) Glass Work Surface #MCM-CBD
- (C) Acrylic roller #MCM-AR
- (E) Chrome Executive Pen Kit #PKEXECPENC
- (F) Tube Size cutter set for 7mm, 8mm, 3/8", 27/64" & 10 mm tubes #MCM-CC
- (G) Polymer clay cane (5 canes styles included in starter set): #MCM-KP06 mixed bouquet, #MCM-KP07 Watermelon, #MCM-KP10 (Blooming Daisy), #MCM-KP11 (Wild Flower), #MCM-KP15 (Stained Glass)

- (H) Polyclay cane slicing jig #MCM-CSJ
- (I) PolyClay cutting blade (2 pack) #MCM-BLA
- (J) Oven thermometer #MCM-TH
- (K) PolyClay Mandrel #MCM-MAN
- (L) Executive Pen Bushing #PKEXECBU
- (M) Abralon sanding pads #MCM-SAP

Optional Poly Clay Crafting items

- Pasta/conditioning machine #MCM-CM
- Aussie oil #PKSWAUS2 or One Step Plastic polish #ONESTEP
- Pen Press #PENPRESS5