

BRASS SEALING STAMP KIT

KIT FEATURES

- Choose from eight unique character stamps:
 - A** PKSTAMP01 - Rose
 - B** PKSTAMP02 - Star
 - C** PKSTAMP03 - Heart
 - D** PKSTAMP04 - Butterfly
 - E** PKSTAMP05 - Sea Shell
 - F** PKSTAMP06 - Sun Burst
 - G** PKSTAMP07 - Mendhi
 - H** PKSTAMP08 - Fluer De Lys
- I** 8mm Screw stud 1-3/8"
- Made from quality brass from Italy.
- Each stamp is 3/4" round x 1/2" tall.
- Project stands 3-1/2" tall with 3" handle attached.

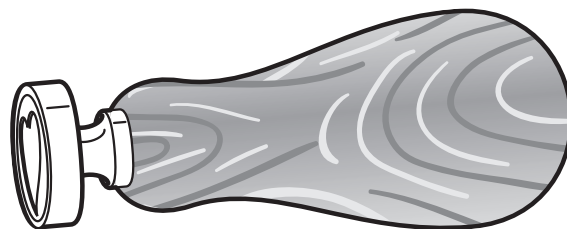
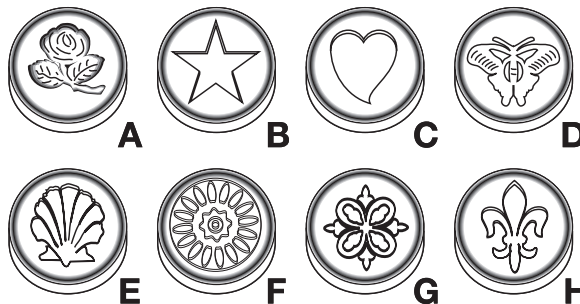

DIAGRAM A - AVAILABLE CHARACTERS



REQUIRED ACCESSORIES

- 8mm Drill bit - PKPARK-8MM
- 60° Heavy duty live center - LCENTLT
- 4-Prong or other drive center - LCENT4
- Insta-cure (cyano acrylate) glue or 2-part epoxy glue

PREPARING THE BLANKS

- Cut a blank 1-1/2" square x 3 to 3-1/2" long.
- Mark the center of the square on both ends.
- Drill an 8mm hole centered in one end 1" deep.



DIAGRAM B - TURNING THE HANDLE

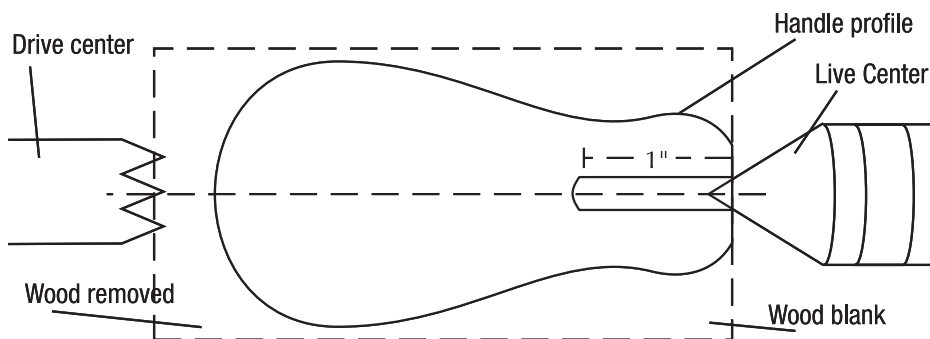

TURNING THE HANDLE

- Mount a drive center into the spindle of the lathe.
- Mount a heavy duty 60° live center in the tail stock.
- Center the blank on the drive center, undrilled end toward the drive center (see Diagram B).
- Slide the tail stock center into the hole on the opposite end.

- Lock the setup in place.
- Turn the wood down to the desired handle profile.
- Sand and finish the wood, using polish, wax or oil.
- Remove the handle from the lathe.

ASSEMBLY

- Squeeze glue into the opening at the handle.
- Insert the 8MM screw stud (I) into the hole, screw will extend out 3/8". Let glue dry. (Refer to Dia C)
- Thread on the brass seal over the screw. Your project is now ready to operate. See reverse for usage instructions.

DIAGRAM C - ASSEMBLY

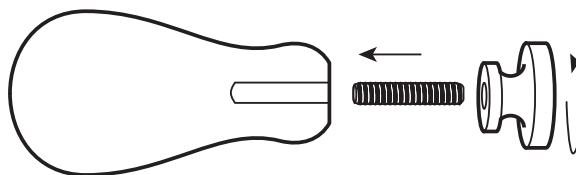

INSTRUCTIONS - To use the stamp

- First close and seal your envelope flap, then moisten the seal stamper thoroughly with a wet sponge or by rubbing a touch of oil over the stamping portion of your seal. Pay special attention to the grooves. This is so that no wax adhere to the stamper.
- Now, light the wick of the stick. Do it just as you would light a candle, except hold it at a 45° angle instead. Drop enough wax on the seal area. You can change the angle of the stick slightly to adjust the flow of the molten wax. Blow out the flame when there is enough wax on the envelope, then take the underside of the stick and blend the molten wax in circular fashion, creating a smooth edge. Hold the stamp there firmly, but briefly; then pull the seal up and you've created your seal!
- Each stick averages 10-12 wax impressions. Genuine sealing wax holds its impression very clearly and has a hard, glossy appearance, different from other non-sealing waxes. Wax sealed envelopes can be mailed but we recommend using an outer padded envelope for extra protection. You can also have the Post office hand-cancel your envelopes, avoiding today's automated sorting machines.

WHEN WORKING WITH AN OPEN FLAME, PLEASE EXERCISE CAUTION AND CARE IN THE USE OF THIS PRODUCT. SEALING WAX IS NOT RECOMMENDED FOR USE BY YOUNG CHILDREN.

HISTORY

For centuries, the seal has served as a stamp of undisputed authenticity, just as a signature is accepted in the world today. During Medieval times the upper and middle classes all owned seals. Royalty would own several seals, including their own "Great Seal", as well as seals for all their courts and officials. It was common practice to destroy a seal once the owner died; therefore very few original seals have survived.

Years ago when betrothals were pre-arranged and true words of love were secretly written and the envelope's contents was secured by a wax seal. The recipient could be assured that their passion would be unknown to others. A broken wax seal implied broken trust... and no person of integrity would tamper with a wax emblem.

During the United States colonial times, Congress realized the necessity for a seal for our newly established nation. Benjamin Franklin, John Adams and Thomas Jefferson created the first seal of the United States on July 4, 1776, immediately after the Declaration of Independence was signed.

By using sealing wax, you too will continue this time-honored tradition of security and integrity. A personal seal will lend dignity, prestige and a personal flair to your correspondence, gift-packaging or craft projects.

DIAGRAM D - FINISHED IMPRESSION

