

Speed Dial Safety Razor Kit

Kit Features:

- Easy and safe blade change mechanism
- Easy to turn with a straight tube
- Minimum parts - easy to assemble
- Tube size: 10mm

Required Accessories:

- 7mm Pen Mandrel
- Drill Bit:#PK10-10
- Bushing set(2 pc): #PKRASAF2BU
- Barrel Trimming set: #PKTRIM10
- Live Tailstock Center
- 2 Part Epoxy Glue or Insta Cure (Cyanoacrylate) Glue
- Pen Blank: Minimum Size - 5/8" x 3-1/2" Long



Diagram D: Twist knob to raise blade cover.

Telescoping
Blade Cover

DIAGRAM A / PARTS LAYOUT

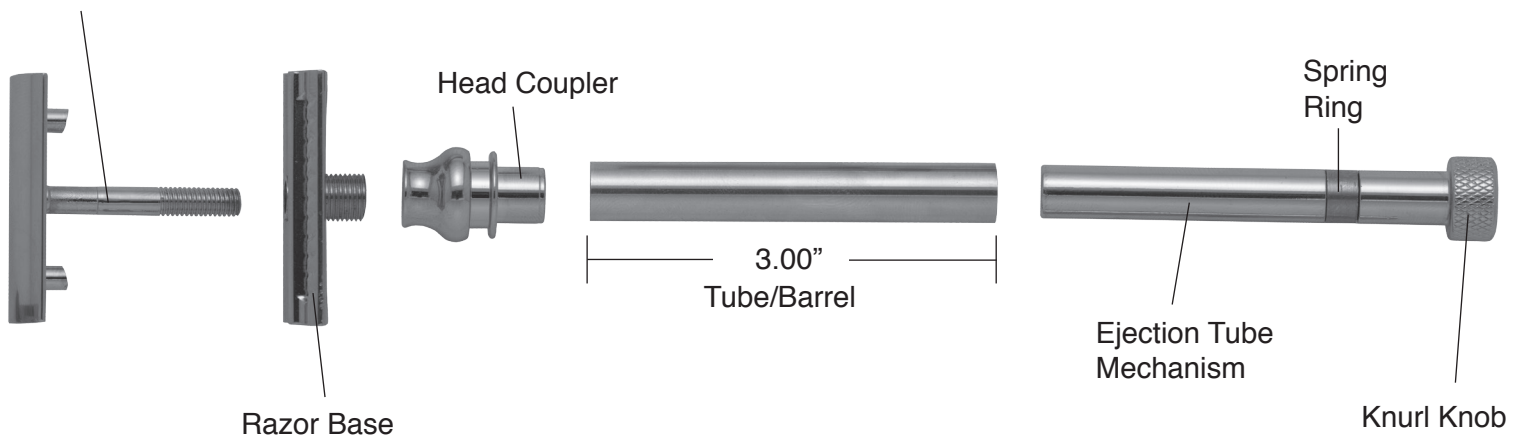

Preparing the Blank:

- Cut 1 blank to the length of the tube and add 1/16" for squaring off.
- Drill a 10mm hole lengthwise through the blank.
- Spread glue over the tube, insert the blank with a twisting motion to spread the glue evenly inside.
- Center the tube lengthwise inside the blank.
- When the glue is dry, square the ends of the blank. Use a 10mm barrel trimmer, or a universal pen blank squaring jig with a power disc sander. Take the excess material down flush with the ends of the brass tube. (do not trim beyond the length of the tube since this may interfere with operation of the mechanism and assembly). Use a barrel trimmer to clean the inside of the tube.

DIAGRAM B / TURNING THE BLANKS

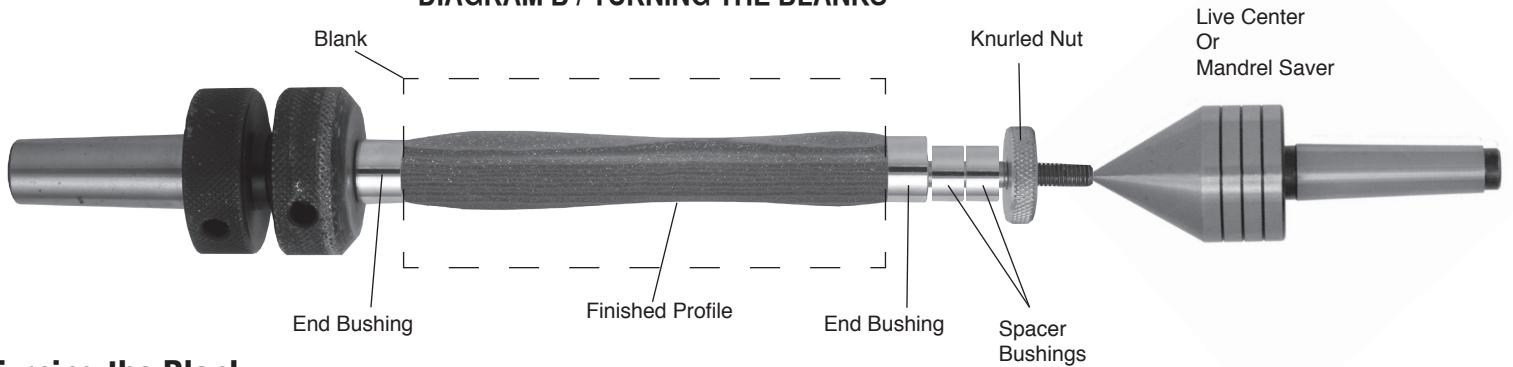
**Turning the Blank**

- Mount the bushings and blank according to diagram B.
- Thread on the knurled nut and hand tighten to hold all components in place.
- Slide the tailstock up snugly against the mandrel shaft inserting the live center point into the mandrel dimple, lock in place.
- Hand tighten the quill adjustment to firm up the mandrel. (DO NOT overtighten, it could damage the mandrel.)
- Using sharp tools, turn the blank down close to the bushing diameter. Turn the barrel (straight or to a profile of your choice)
- Sand the blank down to be flush with the bushings gradually increasing the sandpaper grits.
- Finish the barrel with your choice of polish. Allow sufficient time for the polish to cure.
Refer to polish instructions.

Assembly

- Layout parts according to diagram A
- Press the head coupler extension end into the upper end of the turned barrel
- Thread the razor base into the head coupler (note: this is a permanent connection, thread in tight or glue in).
- Insert the ejection tube mechanism into the bottom of the tube, press the spring ring together to pass into the tube ...press inside until the knurl knob bottoms on the tube.
- Place a safety razor blade (not included) on the razor base, then slide the threaded stem of the telescoping blade cover through the razor blade and razor base into the head coupler
- Twist the knurl knob clockwise to draw down the blade cover onto the blade. To remove the blade, twist the knurl knob counter clockwise. Note that it is not necessary to twist the blade cover to remove the blade. (See dia D for operation)

Diagram C / Bushings #PKRASAF2BU