

# #PKEZPCL Instructions

24kt Gold-plated E-Z Grip Pencil Kit

**FEATURES:**

- Heavy 24kt gold-plating with epoxy coating
- E-Z soft grip makes writing comfortable
- Well balanced design, with stylish contoured components
- Pencil mechanism engages with a one-hand click
- .7mm lead
- Overall length 5-1/2"

**REQUIRED ACCESSORIES:**

- Pen mandrel
- 8mm drill bit **#PKPARK-8mm**
- 8mm barrel trimmer **#PKTRIMKIT**
- 4-pc bushing set **#PKEZBU**
- 2-part epoxy glue or insta cure cyanoacrylate

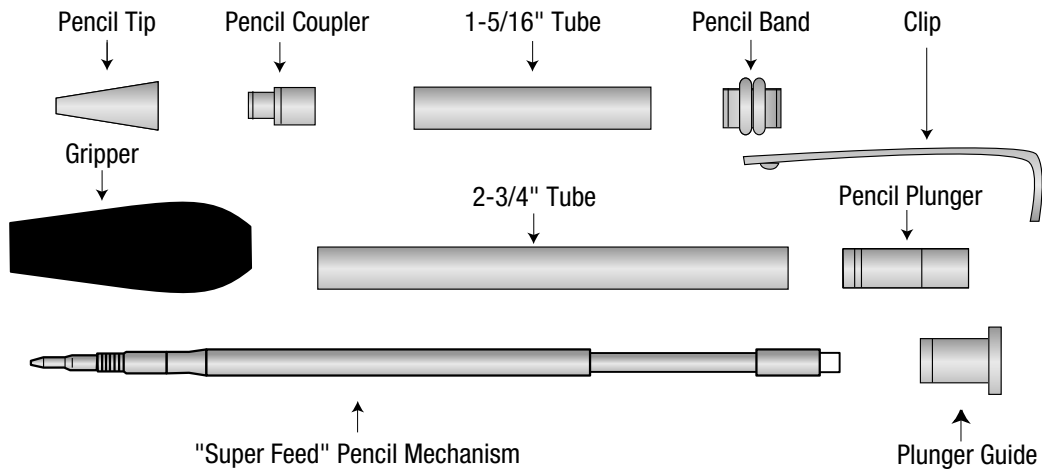
**DIAGRAM A - Pencil Parts****PREPARING THE BLANK FOR TURNING**

*Note: You may make these pencils using the rubber gripper or all wood construction. When making all wood construction use all 3 bushings. When making with gripper, do not use the tip bushing. Instructions below pertain to using the gripper. The all wood option is detailed in DIAGRAM B.*

- Cut 3/4" to 1" square blank to the size of the long tube (add 1/16" for squaring off).
- Drill an 8mm center hole lengthwise through the blank.
- Spread glue over the tube and insert it into the blank with a twisting motion to spread the glue evenly inside the blank.
- Center the tube lengthwise in the blank.
- When the glue dries, square the ends of the blank. Use an 8mm barrel trimmer. Trim the wood, flush to the brass tube.

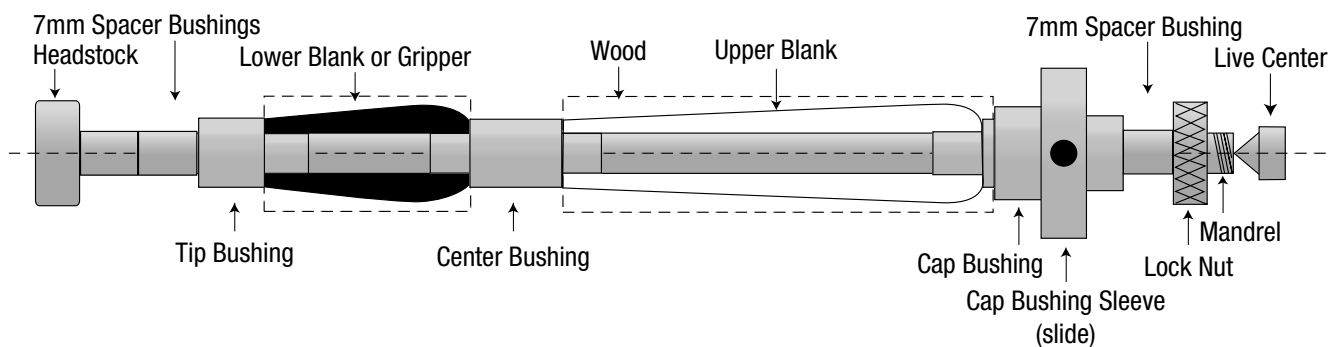
**DIAGRAM B - Turning the Blank**

## TURNING THE UPPER BLANK

- Place 3-4 7mm spacer bushings onto the mandrel, and follow with the center bushing. Slide on the upper blank, follow with the combo/cap bushing narrow end in first. Fill the space to the threads with spacer bushings. Thread on the lock nut hand tight. Bring up the tail stock until it is snug to the mandrel shaft, lock in place, and do not over tighten (it could damage the mandrel). Tighten the lock nut to prevent the blank from spinning. Slide the sleeve snug against the blank lock with set screw.
- Turn the wood in a tapered profile from the center bushing to the cap bushing. Unscrew the set screw and slide the sleeve away from the blank, tighten. Using a skew or other flat cutting tool round the corner of the blank at the end.
- Sand and finish the barrel with your choice of polish and wax.

## DIAGRAM C - Pencil Assembly

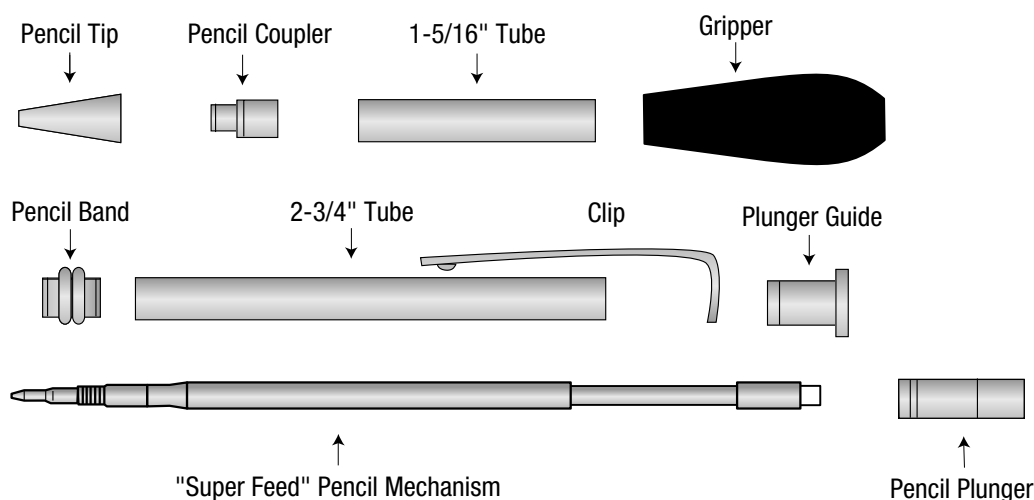

## PENCIL ASSEMBLY

- Press the coupler, recessed end in first, into the exposed short tube.
- Slip the gripper, narrow end toward the coupler over the tube.
- Press the band into the opposite end.
- Press the upper barrel into the band, narrow end first.
- Insert the pencil plunger guide into the hole in the clip.
- Press this assembly into the opposite wide end of the long barrel.
- Insert the pencil mechanism, tip end first, into the pencil through the plunger guide opening to the end.
- Assemble the pencil tip over the thread of the pencil mechanism. Screw the tip on hand tight.
- Insert the plunger over the eraser on the opposite end.
- The pencil is ready to operate by clicking the plunger to extend the lead. To retract the lead, hold the plunger down and press on the lead.

### Bushings #PKEZBU

Tip Bushing

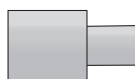

Center Bushing

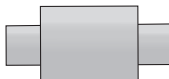

Cap Bushing with Sleeve

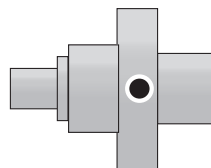

Allen Wrench

