

# Over & Under Rollerball & Fountain Pen Kits

#PKCP6000 #PKCP6010 #PKCP6020

## KIT FEATURES

- Pen represents the popular over/under style shotgun
- Simulated 12ga. shotgun cap
- Simulated .30ml bullet cartridge body
- Roller Ball uses Premium Refill #PK10-RPR
- Fountain Pen uses German made Iridium nib
- Overall length: 6 - 1/2"
- Rose Gold Tip
- Uses a wood color for the cap to simulate 12ga. shotgun

## KIT REQUIRED ACCESSORIES

- 7mm, Pen Mandrel
- 3 pc. bushing set #PKCP6000BU
- 9/16" Drill bit #FB916 for the upper blank
- 12.5mm drill bit #PKPLI-DB for the lower blank
- Trimming Sleeves #PKAPBTS (use with 7mm barrel trimmer shaft)
- 2 Part epoxy glue or Insta Cure (cyanoacrylate)
- Extra tubes #PKCP6000TU (2 Sets)

## DIAGRAM A / B – ROLLER/FOUNTAIN PEN PARTS

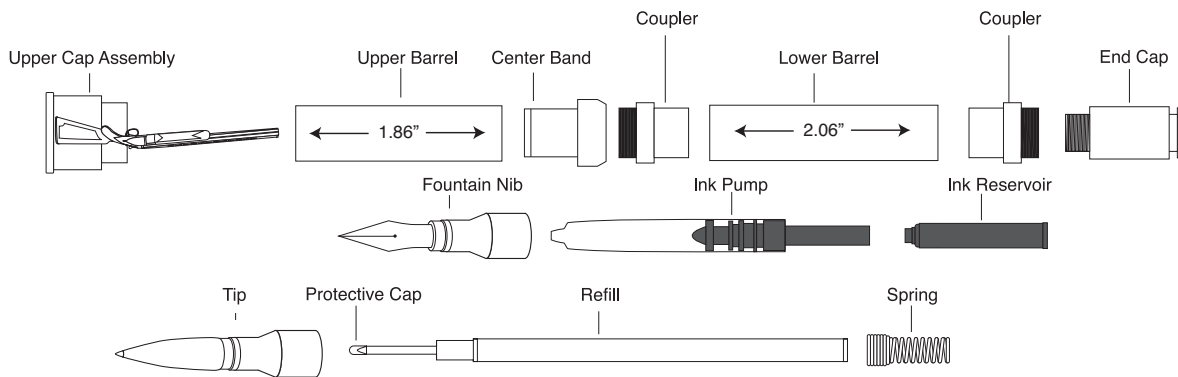

## PREPARING THE BLANKS

- Cut 3/4" or larger pen blanks to the length of the brass tubes (add 1/16" for trimming).
- Drill a 9/16" diameter hole through the upper blank (shorter).
- Drill a .492" diameter hole through the lower blank (longer).
- Spread glue over tubes. Insert each into the proper barrel with a twisting motion to spread the glue evenly in side.
- When the glue dries, trim the ends of each blank. Use a 7mm barrel trimmer with adapter sleeves (#PKAPBTS). Take the excess wood down to the brass tube. (Do not trim beyond the length of the tube since this may interfere with operation of the mechanism and assembly. Use a barrel trimmer to clean the inside of the tube.

## DIAGRAM C – TURNING THE BLANKS

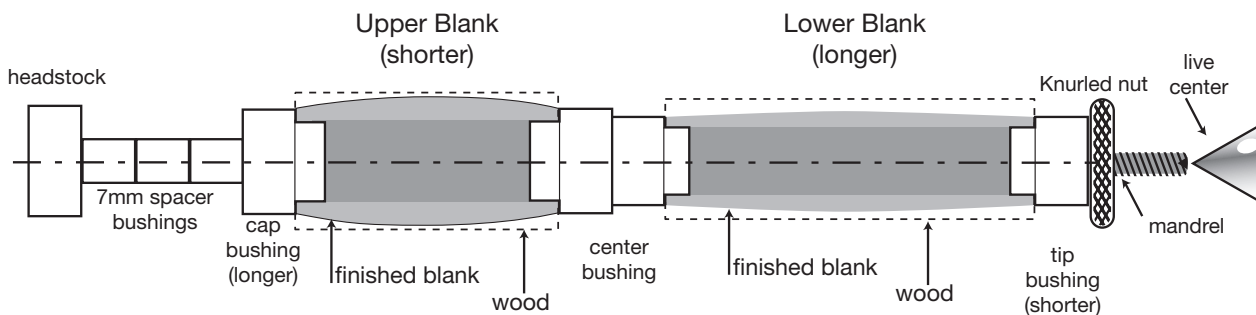

## TURNING THE BLANKS

- Slide spacer bushing onto the mandrel shaft, followed by the longer bushing, wide end in first. Slide on the upper blank (shorter). Add the center bushing, wider section in first. Add the center bushing, wider section in first. Place the lower blank (longer) followed by the shorter end bushing, smaller end first. Add Additional spacer bushings as necessary to reach the mandrel shaft threads.
- Thread on the knurled nut hand tight. Bring the tailstock in snug to the mandrel, lock in place. Do not over tighten the knurled nut, it could damage the mandrel.
- Turn the barrels close to the bushing diameter with sharp tools; sand the barrels to match the bushing diameter.
- Finish the wood with your choice of polish.

### DIAGRAM D - FOUNTAIN PEN / ROLLER BALL

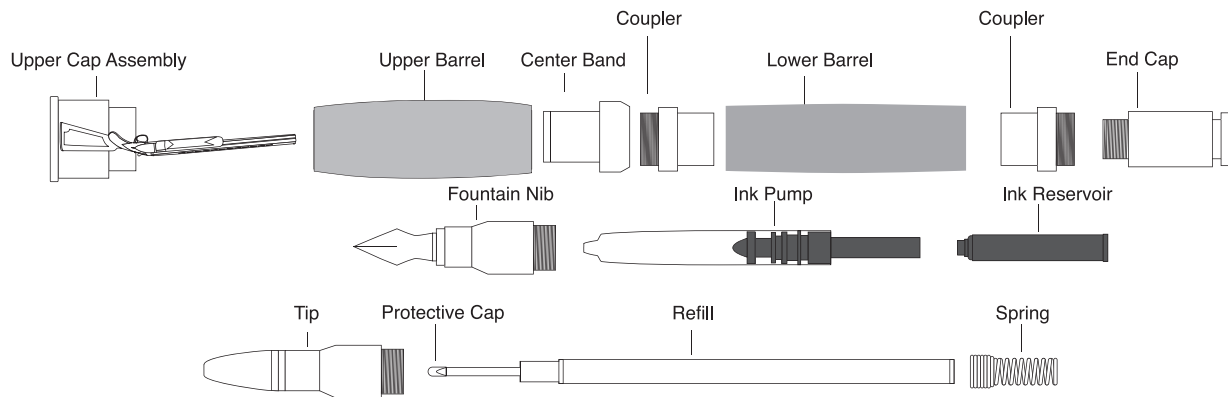

*NOTE: Please do not press the front end of this kit with the tip removed. If you do so the parts will not assemble properly and you will void our warranty*

## ASSEMBLY

*NOTE: Line up the components according to Diagram D*

- Insert the upper cap assembly, narrow end first into the upper barrel, press in.
- Insert the center band, narrow end in first into the opposite end of the barrel.

## FOUNTAIN PEN

- Insert the ink cartridge narrow end first into the opening at the rear of the fountain tip assembly. Squeeze the cartridge lightly to advance the link forward to the nib.
- Thread the fountain nib assembly on to the coupler.
- To use the refillable pump. Just mount the clear end of the pump into the nib assembly. Turn the black knob until the piston is down. Insert the nib into an inkwell. Turn clock wise to draw ink into the pump.

- Press each coupler, narrow end first into the openings at the lower barrel
- Affix the end cap into either one of the couplers

## ROLLER BALL

- Drop the refill spring into the barrel.
- Discard the protective cap from the refill. Insert the refill, wide end in first into the opening.
- Thread the roller tip into the coupler.
- The roller ball pen is ready to operate.

### BUSHINGS #PKCP6000BU

