

# Big Ben Click Pen

PKBIGCPI • PKBIGCP2 • PKBIGCP3

## REQUIRED ACCESSORIES

- 7mm, Pen Mandrel
- 3 pcs. Bushing Set #PKBIG-BU
- 10mm Drill Bit #PK10-10
- Universal Barrel Trimming #PKTRIMKIT (Use 10mm)
- 2 Part EpoxyGlue or Insta Cure (cyanoacrylate) glue
- Pen uses Parker® Style refill
- Overall length: 5 3/4

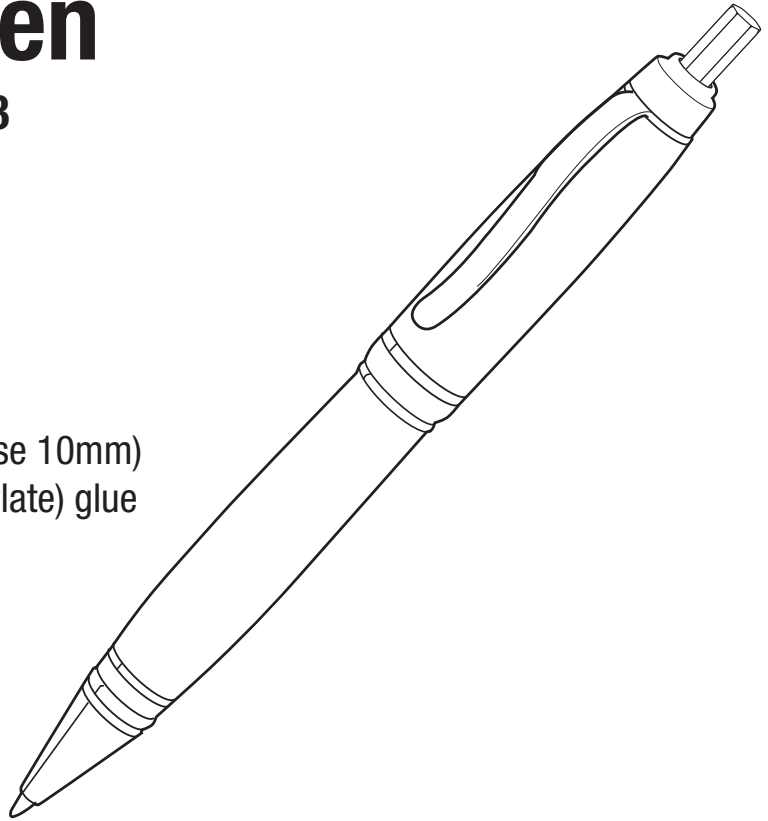

## DIAGRAM A / PART LIST.

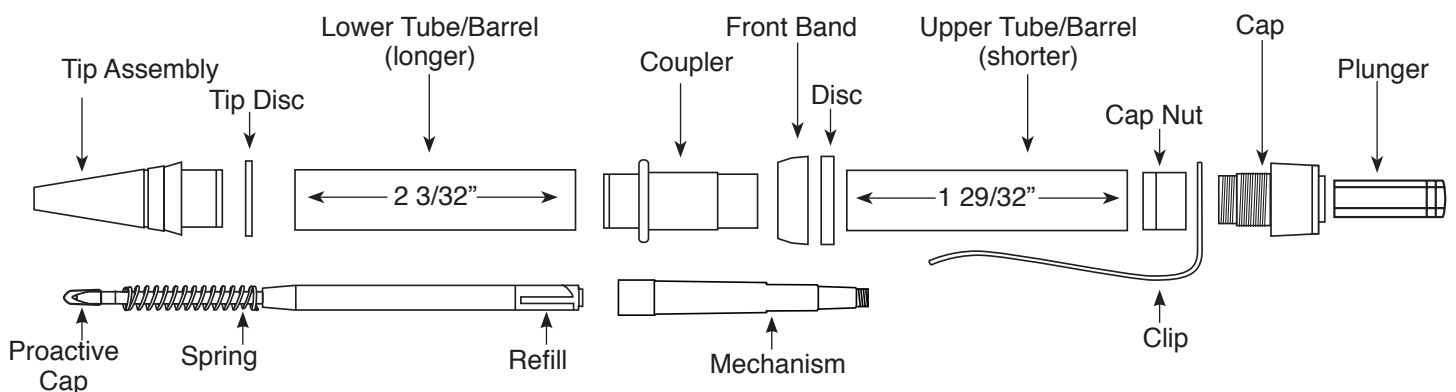

## PREPARING THE BLANKS

- Cut the blanks to the size of the brass tube (add 1/16" for trimming)
- Drill 10mm hole, through each blank.
- Glue each tube in the blank. Insert with a twisting motion to spread the glue evenly inside the blank.
- When the glue dries, use a universal squaring jig or a 10mm barrel trimmer.  
Trim the wood down, flush to the brass tube.

### DIAGRAM B / Turning the Blanks

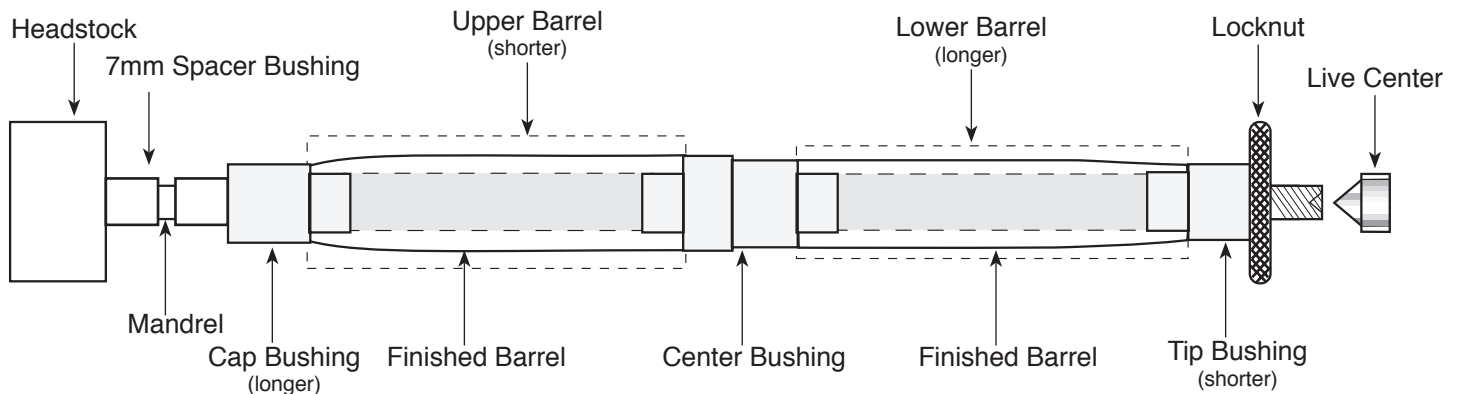

### TURNING THE BLANKS

- Mount the bushings and blanks on the mandrel according to Diagram “B”
- Turn the wood down, close to the size of the bushings. Sand the wood to the bushing diameter.
- Finish the wood with your choice of polish.

### ASSEMBLY *Note: Layout finished parts according to Diagram A*

- Insert the tip disc over the extension on the tip, press this assembly into the narrow wood end of the lower barrel.
- Insert the coupler, short extension in first into the opposite end of the lower blank. Press in.
- Insert the cap nut, recess end in first into the narrow end of the upper barrel. Press in.
- Affix the clip into the cap, screw into the nut.
- Insert the front band, narrow end in first and disc over the exposed end of the coupler. Screw in the mechanism assembly and press this assembly into the opposite end of the upper barrel.
- Insert in the plunger through the opening at the cap screw in tight.
- Remove the front tip, insert the refill and spring, replace tip, tighten over the refill.
- Pen is ready to operate by pressing on the plunger to extend or retract the refill.

### DIAGRAM C / PKBIG-BU

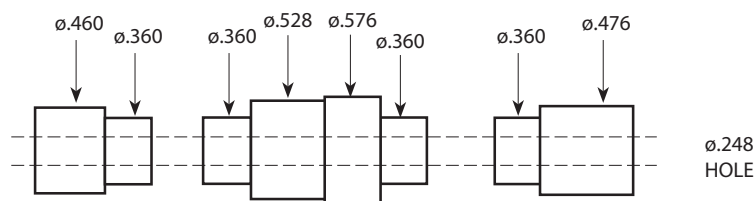

Philadelphia, PA 19115