

## Perfume Atomizer Kit

### KIT FEATURES

- 24kt Gold Plating Finish
- Unique design
- Overall length 3-1/4" or 3-1/2"
- Reservoir able to hold any liquid

### REQUIRED ACCESSORIES

- 7mm Pen Mandrel
- 3-piece Bushing Set—#PKATOM-BU
- 15mm HSS Drill Bit—#PKATOM-DB
- 7mm barrel trimmer #PKTRIM7 or Universal barrel trimmer system #PKTRIMKIT
- Insta-cure glue (cyano acrylate) or 2-part epoxy glue

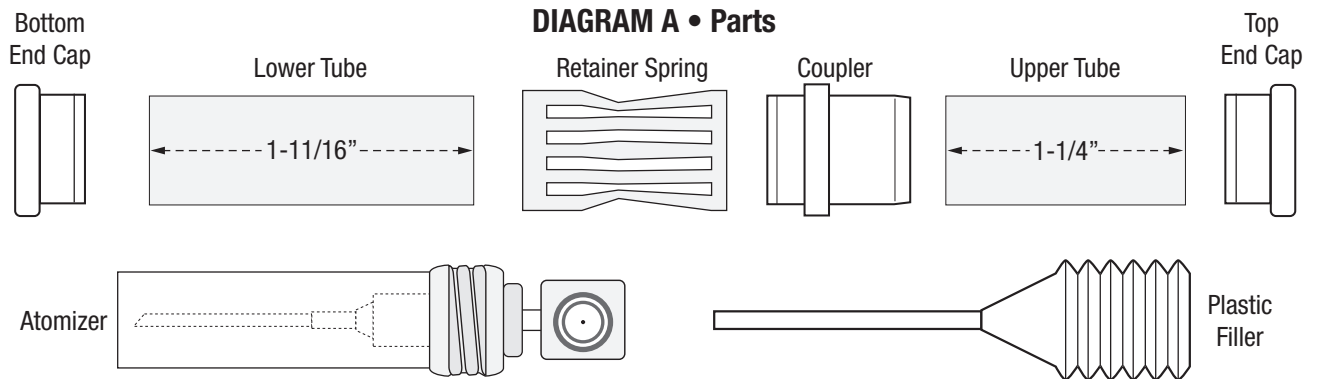

### PREPARING THE BLANKS

- From 7/8" or larger square stock cut blanks to the length of the tubes plus 1/16". Grain should run lengthwise.
- Drill a centered hole lengthwise through each blank. For best results—use a 15mm HSS drill bit—#PKATOM-DB
- Spread the glue evenly on the outside of the tube and insert into the blank with a twisting motion. Center the tube within the blank and allow to dry.
- When the glue dries, square the ends of the blank. Use a universal pen blank squaring jig, or belt/disc sander to square the ends of the blanks. Take wood down to brass tubes as needed.

### TURNING THE BLANKS

- Install a 7mm pen making mandrel on the lathe, and live center onto tailstock. Refer to **DIAGRAM B**.
- Place three spacer bushings on the mandrel. Place the tip bushing on, followed by the lower blank.
- Insert the center bushing on mandrel, followed by the upper blank. Insert the cap bushing.
- Thread the lock nut hand tight onto the 7mm mandrel. Do not overtighten, it could damage the mandrel.
- Bring tailstock snug to the mandrel, lock it into place. Tighten the lock nut for turning.
- Using sharp tools, turn the blank down; sand it to the to the size of the bushings.
- Finish the blank with your choice of polish.

### DIAGRAM B • Turning The Blanks

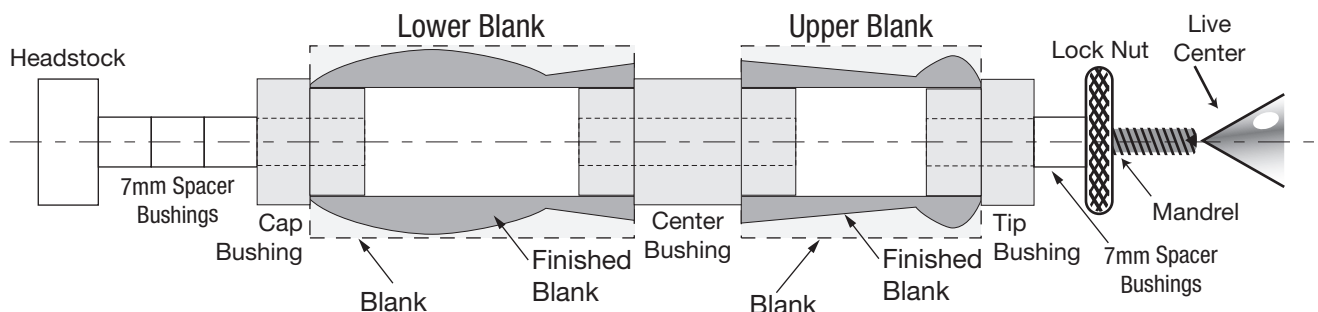

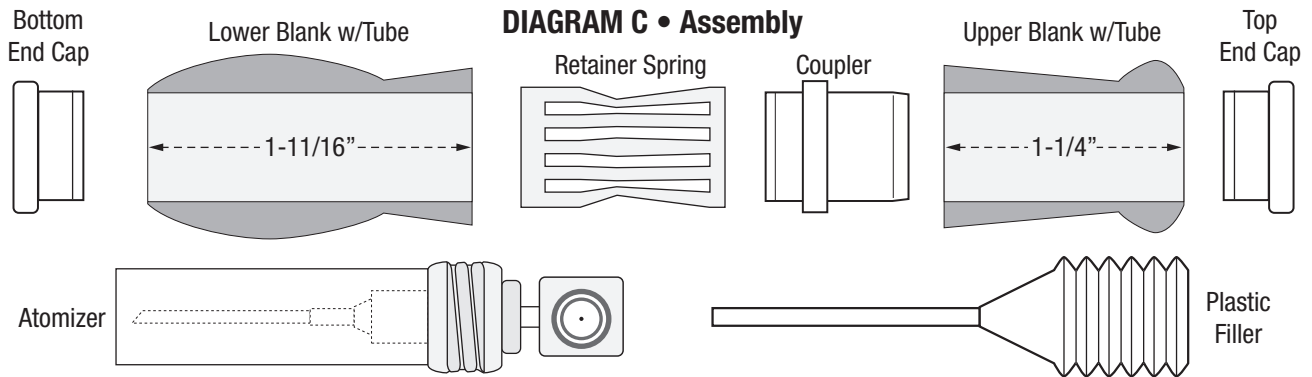

**ASSEMBLY**

- **NOTE:** The PKATOM2 has convex ends and a multiple ring design on the coupling, and a ring on each end.
- **HINTS:** Use a clamp or vise with wood jaws to press parts together, squeeze slowly. Top and bottom tubes are different. Be sure to assemble the coupling properly.
- Align atomizer parts according to the **DIAGRAM C**.
- Press an end piece into the top of the short blank and the bottom of the long blank.
- Press the short end of the coupling into the open end of the long blank.
- Insert the retainer spring flat end first into the long blank past the coupling through to the bottom.
- Fill the atomizer with your perfume or other liquid using the plastic filler.
- Insert the atomizer into the long blank where the retainer will secure it.
- Push two halves together aligning grain as desired.

**BUSHINGS**

**DIAGRAM D • PKATOM-BU**

