

David Broadwell's Art Deco Ballpoint Pen Kit Instructions

KIT FEATURES

- An original Art Deco design
- Pen components enhanced with a crystal on the clip
- Gold Titanium Nitride Plating
- Uses high quality Parker® style refill
- Overall length: 5-1/4"

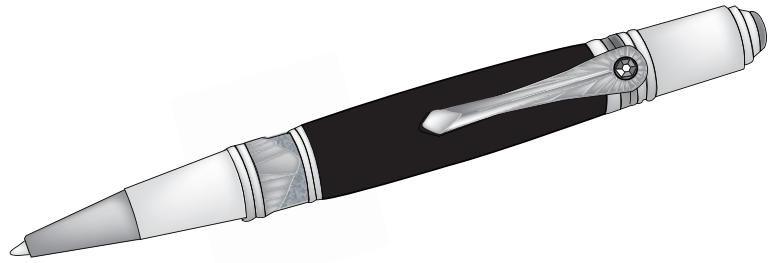

REQUIRED ACCESSORIES

- 7mm Pen Mandrel
- 3/8" Drill Bit #PKEXEC-3/8
- 2-piece bushing set #PKMAJSQBU
- 3/8" Barrel Trimmer #PKTRIMKIT
- 2-part epoxy glue or insta cure (cyanoacrylate) glue

DIAGRAM A – PARTS LIST

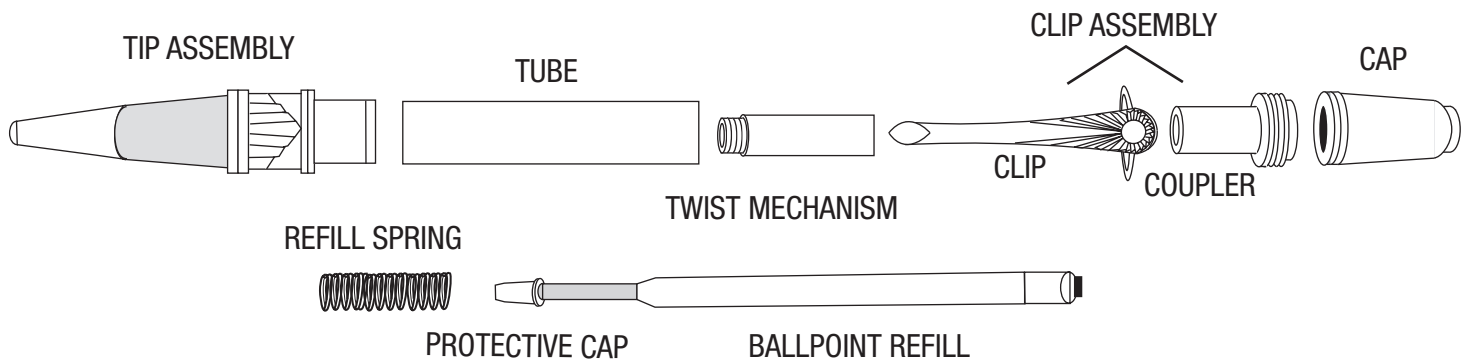

PREPARING THE BLANKS

- From 3/4" square stock, cut the wood or acrylic blank to the length of the brass tube. Add 1/16" for squaring off.
- Drill 3/8" center hole lengthwise through the blank.
- Glue the brass tube in the blank. Spread the glue on the tube. Insert into the blank with a twisting motion to spread the glue evenly inside. Center the tube lengthwise in the blank. Allow it to dry.
- After the glue dries, use a 3/8" Barrel Trimmer to square the ends of the blank flush with the ends of the brass tube.

DIAGRAM B – TURNING THE BLANK

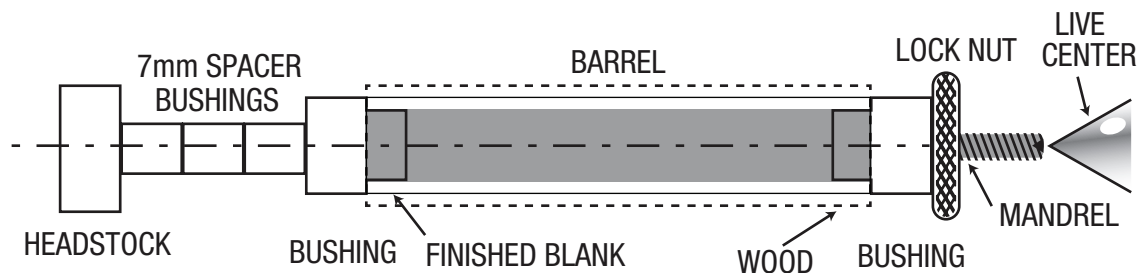

TURNING THE BLANK

- Place spacer bushings onto the pen mandrel. Slide an end bushing onto the mandrel, wide end first. Insert the blank and follow with the second bushing (narrow end first). Add additional spacer bushings to close the space to the threads on the mandrel. Thread the lock nut onto the mandrel hand-tight. Bring the tailstock in snug with the mandrel. Do not overtighten – this could damage the pen mandrel. Lock the nut and the tailstock in place.
- Turn the blanks down close to the bushings located at the ends of the blanks. Sand the blanks down to the bushings.
- Finish the turned barrels with your choice of PSI polish.

DIAGRAM C – ASSEMBLY

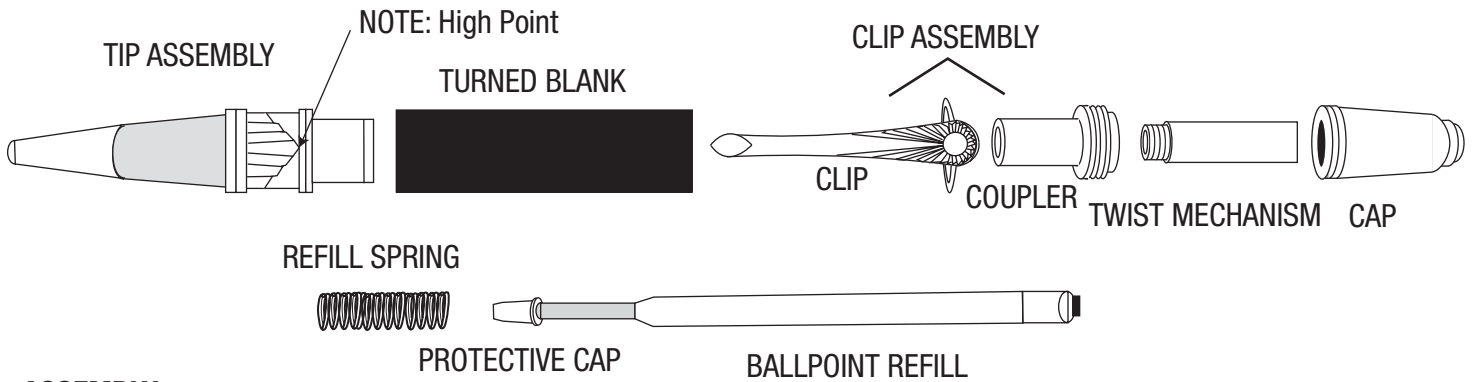

ASSEMBLY

- Press the tip assembly into either end of the barrel.
- Insert coupler into clip. Press the clip assembly into the opposite end of the barrel. **IMPORTANT:** The clip should align with the high point of the band design on the tip assembly.
- Remove the protective cap off the refill. Place the spring over the refill tip, then insert the refill into the opening at the top of the pen.
- Screw the twist mechanism over the refill.
- Place the cap over the exposed end of the mechanism and press in.
- The pen is ready to operate. Just twist the cap from one position to another to extend or retract the refill
- To change the refill, unscrew the twist mechanism.

**DIAGRAM D – BUSHINGS
PKMAJSQBU**

